



Premium Outdoor Camera

Installation Manual



Installation Support:
(877) 998-1457
AAA.com/SmartHome-Install

Camera Installation Parts

- Premium Outdoor Camera
- AC Power Adapter
- Three (3) Wall Anchors & Screws
- Rubber Plug

Tools Required

- Screwdriver
- Wi-Fi connection to broadband (Cable, DSL, or Fiber Optic) internet
- A computer, tablet, or smartphone with Wi-Fi is required if the router does not have the Wi-Fi Protected Setup (WPS) feature

Pre-Installation Instructions

Important: A rubber plug has been included with the Premium Outdoor Camera at the base of the mount. This rubber plug should only be used if the device is being mounted directly over a hole in the wall. The rubber plug will provide a seal to prevent water from entering the gap in the wall behind the camera. In all other installations, please remove the rubber plug. Removing the rubber plug will allow you to route the power cable through the hole without bending or breaking the cable.

Connect the Premium Outdoor Camera to the Wi-Fi network.

The Premium Outdoor Camera can be connected to the Wi-Fi network using Bluetooth Enrollment (BLE) mode, Access Point (AP) mode, or Wi-Fi Protected Setup (WPS) mode.(i.e., FRONT and TRANS or REAR and TRANS), leaving the existing wires in place. Polarity does not matter.

BLE Mode (Recommended)

1. Plug the video device into a non-switched electrical outlet. Wait for the device LED to begin blinking white. If the LED is not white after two minutes, press and hold the **Reset** button and release when the LED begins to blink white (about three seconds).
2. On a Bluetooth-enabled mobile device, such as a laptop or, optimally, a smartphone, log in to the A3 Smart Home Mobile App and complete the following steps to add the video device to the account.

3. Log in to the A3 Smart Home Mobile App.
4. Tap **More**.
5. Tap **Add Device**.
6. Tap **Video**.
7. Scroll to find the device or use the Find Device search bar to enter the model number, then tap to add the selected device.
8. Enter a Device Name, then tap **Next**.
9. Power on the device and verify the LED light is flashing white, then tap **Next**.
 - a. If it is not flashing white, press and hold the button until the status LED starts blinking white. This may take several seconds.
 - b. Tap **Troubleshoot** to learn more about how to get the device to that state.
10. If Bluetooth is not enabled on your mobile device, approve the Bluetooth permission request when prompted, then tap **Next**.
11. Bring your mobile device close to the device being enrolled, then tap **Scan**.
12. Allow time for your mobile device to scan for devices in the area.
13. Select the device to set up. Verify the selected device's MAC address matches the MAC address on the device being enrolled, then tap **Connect**.
14. Keep your smartphone near the device while it connects.
15. Once your smartphone is connected to the device, tap to select the Wi-Fi network. Either:
 - a. Select a known network in *My Wi-Fi Networks*, or
 - b. Select a new network in *Other Networks*, enter the password for the Wi-Fi network, then tap **Connect**.
16. Allow a few minutes for the device to connect to the network.
17. Once the device connects to the Wi-Fi network, the device will continue the installation process on your account. Once the installation is complete, verify the video device works properly.

AP Mode

To ensure the device will have a sufficient Wi-Fi signal, complete the following steps with the camera near its final location but prior to mounting.

1. Connect the camera's AC power adapter and plug it into a non-switched outlet.
2. The camera's LED will begin to blink white. If the LED is not white after two minutes, press and hold the WPS/Reset button and release when the LED begins to blink white (about three seconds).
3. On an internet-enabled device, connect to the Wi-Fi network ADC-V730 (XX:XX:XX) where XX:XX:XX is the last six characters of the ADC-V730's MAC address, which is located on the camera or the packaging.
4. On the same device, open a web browser and enter <http://v730install.com> or **192.168.1.1** in the URL field. Follow the on-screen instructions to add the ADC-V730 to the Wi-Fi network. The LED will briefly turn red before blinking green. The LED will be solid green when the connection is complete.

Once the device is connected to the Wi-Fi network, proceed to Enroll the Premium Outdoor Camera to the account.

WPS Mode

To ensure the device will have a sufficient Wi-Fi signal, complete these steps with the camera near its final location but prior to mounting.

1. Connect the camera's AC power adapter and plug it into a non-switched outlet.
2. After the startup process is complete (the camera's LED will be blinking white), press and hold the WPS/Reset button and release when the LED begins to blink blue (about six seconds).
3. Activate WPS mode on the router. The camera will begin to connect to the Wi-Fi network. The LED will be solid green when the connection is complete.

Once the device is connected to the Wi-Fi network, proceed to Enroll the Premium Outdoor Camera to the account.

Enroll the Premium Outdoor Camera to the account.

The Premium Outdoor Camera can be enrolled to a customer account using the MobileTech app, website, or A3 Smart Home Mobile App.

To enroll the Premium Outdoor Camera using the A3 Smart Home Mobile App:

1. Log in to the A3 Smart Home Mobile App.

2. Tap **More**.
3. Tap **Add Device**.
4. Tap **Video Camera**.
 - If the device LED is not solid green, tap ADC-V730 for the installation tutorial. If the device is already connected to Wi-Fi and has a solid green LED, continue to the next step.
5. Tap Enter **MAC Address**, then enter the camera's MAC address, which is located on the device or packaging.
6. Tap **Install** for the camera on the *Device Found* page.
7. Enter a device name, then tap **Next**.
8. Follow the on-screen instructions to finish adding the camera. The installation progress displays on the screen.

Once the installation is complete, unplug the camera and install it in its final location.

To enroll the Premium Outdoor Camera using the website:

1. Navigate to the Video Device Setup page by entering the following URL using a web browser: **www.alarm.com/addcamera**.
 - If the installation tutorial was used, it automatically navigates to this page after completing the tutorial.
2. Enter the MAC address, which is located on the device or packaging, then click **Find**.
3. Enter a name for the device, then click **Install**.
4. Follow the on-screen instructions to finish adding the camera. An installation progress bar displays on the screen.

Once the enrollment process is complete, unplug the camera and install it in its final location.

Install the Premium Outdoor Camera in its final location.

Note: Verify that there are no obstructions near the camera's installation location. Obstructions close to the camera's lens can lead to poor night vision performance.

1. Use the included drill template to mark the desired location of the holes for the power cable and mounting screws. Drill a 1/2" hole in the center of the template for the power cable. If mounting

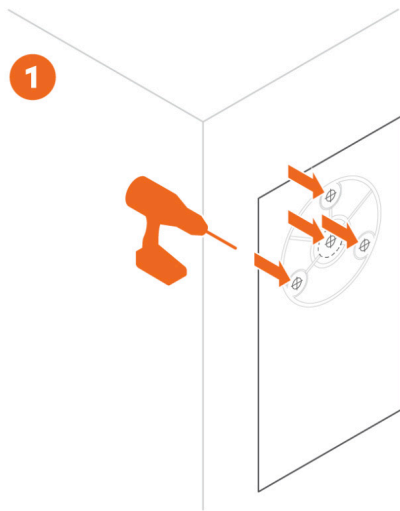

to drywall, drill three 9/32” holes and insert the included M5 wall anchors. If mounting to a solid surface (e.g., wood), drill three 1/8” pilot holes.

2. Mount the device to a flat surface (e.g., a wall or ceiling) eight feet or more above the ground.

To mount the **Premium Outdoor Camera** when routing the power cable through the wall:

1. Install the rubber plug over the hole for the power cord.
2. Connect the 12 VDC connector to an unplugged 12 VDC adapter. Insert the power cable into the center hole.
3. Line up the camera with the three holes created in Step 1. Use the included ST4.8 x 32mm self-tapping screws to fasten the camera to the mounting surface (#10 drywall screws or 3/16” Tapcon screws are also acceptable).

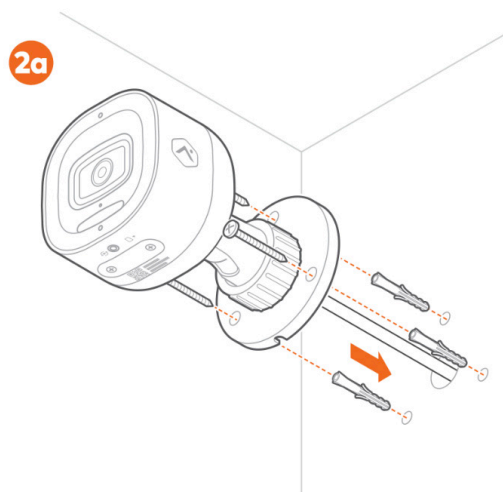

To mount the Premium Outdoor Camera when routing the power cable along the wall:

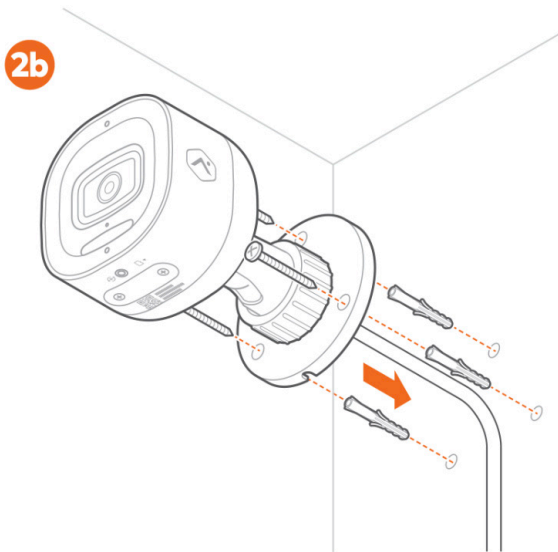

1. Remove the rubber plug from the power cord.
2. Connect the 12 VDC connector to an unplugged 12 VDC adapter.
3. Line up the camera with the three holes created in Step 1. Use the included ST4.8 x 32mm self-tapping screws to fasten the camera to the mounting surface (#10 drywall screws or 3/16" Tapcon screws are also acceptable). Route the cable through the cut-out in the mounting plate.

LED reference guide

LED pattern

Off



Description

Power off

Solid green



Connected to Alarm.com

Blinking green



Local network connection

Blinking red



Power on, camera booting

Solid red



No local or internet connection

Blinking white



Bluetooth and Wi-Fi Access Point modes (press and hold the button for 3-6 seconds)

LED pattern

Blinking blue



WPS mode (press and hold button for 6-9 seconds)

Blinking yellow



Power cycling (press and hold button for 9-12 seconds)

Blinking red and green



Reverting to factory default settings (press and hold the button for 12-15 seconds)

Blinking green and blue



Firmware updating

Troubleshooting

1. If you have issues connecting the camera to the account, power cycle the camera and try again.
2. If issues persist, reset the camera to factory defaults. Press and hold the WPS/Reset button until the LED flashes green and red (about 12 seconds), then release the button. The camera will reboot to factory default.

If the camera was previously installed on a different Alarm.com account, it will need to be deleted before it can be installed again.

Caution: Prolonged exposure to sunlight in extreme conditions may impact the camera's performance. The optimal installation location is in a shaded area, such as under an eave.

Regulatory Statements

Operating Temperature: -40°F-122°F (-40°C-50°C)

Ingress Protection: IP66

FCC Statements

FCC Short Part 15 Statement

This device complies with part 15 of the FCC Rules. Operation is subject to the following two conditions: (1) This device may not cause harmful interference, and (2) this device must accept any interference received, including interference that may cause undesired operation.

FCC Long Part 15 Statement

This equipment has been tested and found to comply with the limits for a Class B digital device, pursuant to part 15 of the FCC Rules. These limits are designed to provide reasonable protection against harmful interference in a residential installation. This equipment generates, uses, and can radiate radio frequency energy and, if not installed and used in accordance with the instructions, may cause harmful interference to radio communications. However, there is no guarantee that interference will not occur in a particular installation.

If this equipment does cause harmful interference to radio or television reception, which can be determined by turning the equipment off and on, the user is encouraged to try to correct the interference by one or more of the following measures:

- Reorient or relocate the receiving antenna.
- Increase the separation between the equipment and receiver.
- Connect the equipment to an outlet on a circuit different from that to which the receiver is connected.
- Consult the dealer or an experienced radio/TV technician for help.
- Changes or modifications not expressly approved by the party responsible for compliance could void the user's authority to operate the equipment.

RF Exposure

This equipment complies with FCC and ISED radiation exposure limits set forth for an uncontrolled environment. This equipment should be installed and operated with a minimum distance of 8 in/20cm between the equipment and your body. This device and its antenna(s) must not be co-located or operating in conjunction with any other antenna or transmitter. Please contact intsupport@alarm.com for more information on Canadian RF exposure compliance.

FCC ID

FCC ID: YL6-143V730

ISED Statements

Condition

This device contains licence-exempt transmitter(s)/receiver(s) that comply with Innovation, Science and Economic Development Canada's licence-exempt RSS(s). Operation is subject to the following two conditions:

1. This device may not cause interference.
2. This device must accept any interference, including interference that may cause undesired operation of the device.

Cet appareil contient des émetteurs/récepteurs sans licence qui sont conformes aux RSS sans licence d'Innovation, Sciences et Développement économique Canada. L'exploitation est soumise aux deux conditions suivantes :

1. Cet appareil ne doit pas provoquer d'interférences.

2. Cet appareil doit accepter toute interférence, y compris les interférences susceptibles de provoquer un fonctionnement indésirable de l'appareil.

RF Exposure

Cet appareil est conforme aux limites d'exposition aux radiofréquences établies par la FCC et l'ISED pour un environnement non contrôlé. Cet appareil doit être installé et utilisé à une distance minimale de 20 centimètres entre l'appareil et votre corps. Cet appareil et son ou ses antennes ne doivent pas être situés ou fonctionner en conjonction avec une autre antenne ou un autre émetteur. Veuillez communiquer avec intsupport@alarm.com pour obtenir plus d'information sur la conformité aux exigences canadiennes en matière d'exposition aux radiofréquences.

IC ID

ID: 9111A-143V730

EU Declaration of Conformity Statement

Hereby, Alarm.com Incorporated declares that the equipment type ADC-V730 is in compliance with Directive 2014/30/EU. The full text of the EU declaration of conformity is available at the following internet address: <https://www.alarm.com/about/international/eu-red>

**Complies with
IMDA Standards
DB108037**